



REQUEST FOR QUOTATION (RFQ)
(ALL ENTRIES ARE MANDATORY)

Name of Owner/ Corporation/ Cooperative/ Agency: _____

QUOTATION NO. : 212

Name of Business : _____

DATE: 02-04-2025

Address: _____

P.R. NO. : 2026-01-IGF-18

Email address: _____ Telephone No. _____

ABC: Php256,800.00

FUND SOURCE: IGF

The Benguet State University through its Bids and Awards Committee will undertake NP-SVP
for the item/s listed below under the following terms and conditions:

1. All entries must be written legibly and accurately.
2. Delivery period is within 60 calendar days.
3. Warranty period shall be for a minimum of three months, in case of expendable supplies, and a minimum of one year in case of non- expendable supplies from date of acceptance by the University.
4. Price validity shall be for a period of 30 calendar days.
5. Compliance with specifications: Kindly specify in the column provided below whether the offer fully complies with the specifications or a counter offer.
6. Deadline of submission of quotation is on or before 5:00pm of Feb. 10, 2026. Offers may be submitted in sealed or open quotation in person, or through facsimile (074-661-1839) or email (procurement@bsu.edu.ph)
7. The item/s shall be procured by: a) line item; X b) lot; c) sub-lot
8. Business Permit Number : _____, date of issue: _____, place of issue: _____
(If renewal of Business Permit is still on process, please indicate OR
No: _____, date of OR : _____ for the payment of renewal).
9. * PhilGEPS Registration Number: _____

JOSEL M. FLORENTIN

Chairperson, BAC (Goods & Services)

College/Dept./Office: CVM

Item No.	Qty	Unit	Item	Technical Specifications (Brand and Model)		ABC	Unit Cost	Total Cost
				COMPLY	COUNTER OFFER			
1		lot	Fabrication and delivery of wooden tables and chairs (details are indicated in the attached sketches; All parts are lumber)			256,800.00		
	15	pc	Chair (High)					
	10	pc	High Tables					
	2	pc	Oval Table (6 seaters)					
	5	pc	Round Table					
	1	pc	Detachable table					
	1	pc	Oval Table (6-8 seaters)					
			TOTAL					
			XXXXXXXXXXXX					

Counter offers:

Delivery Period: _____

Warranty: _____

Price Validity: _____

We hereby submit our quotations, accept the general conditions for the above items and be bound by our offer.

Signature over Printed Name

Date and Time of Receipt of RFQ

* Not a ground for disqualification for failure to indicate but required as a condition for award.

Hard lumber seat
Polished
Maple brown paint (full)

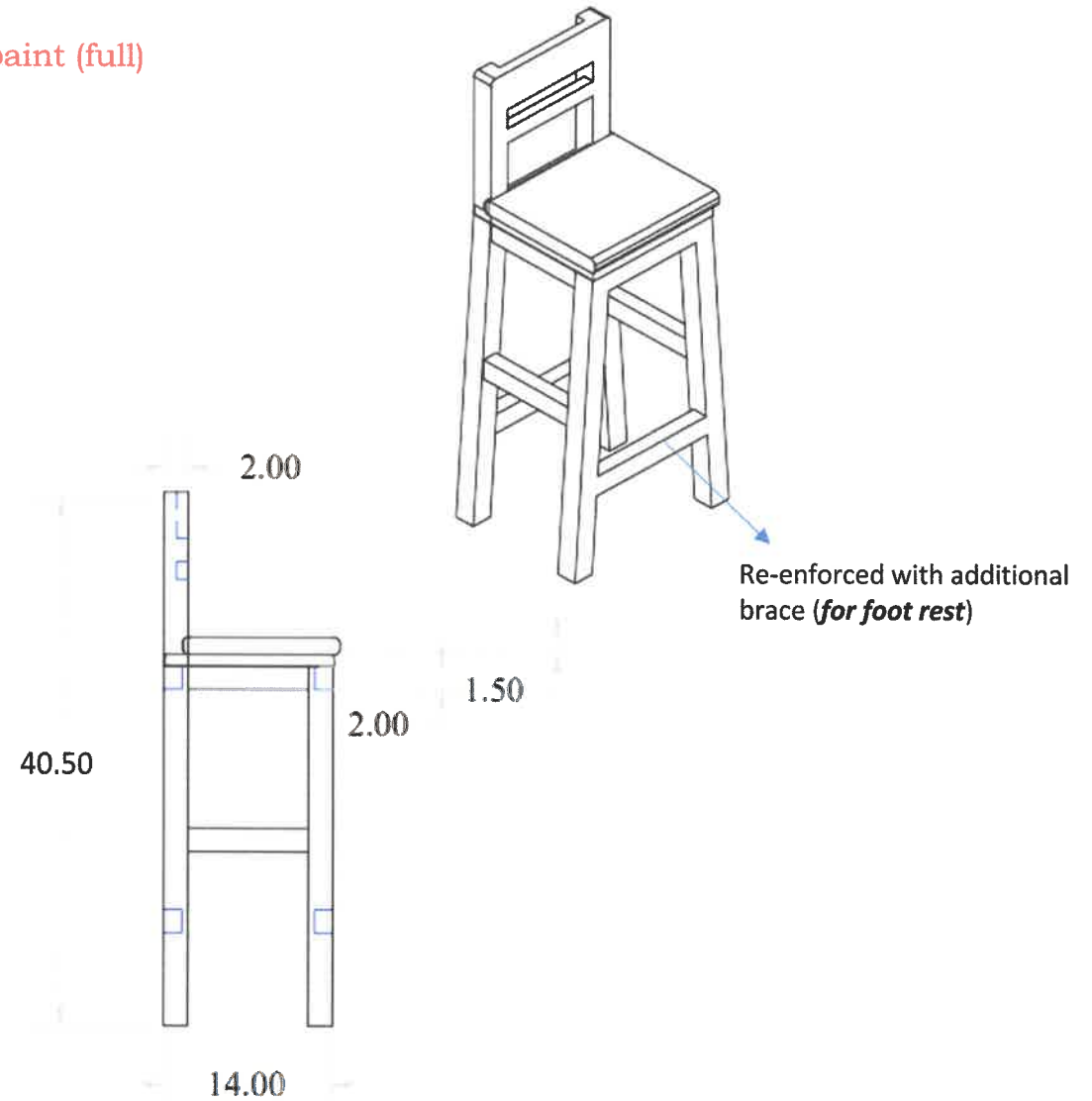
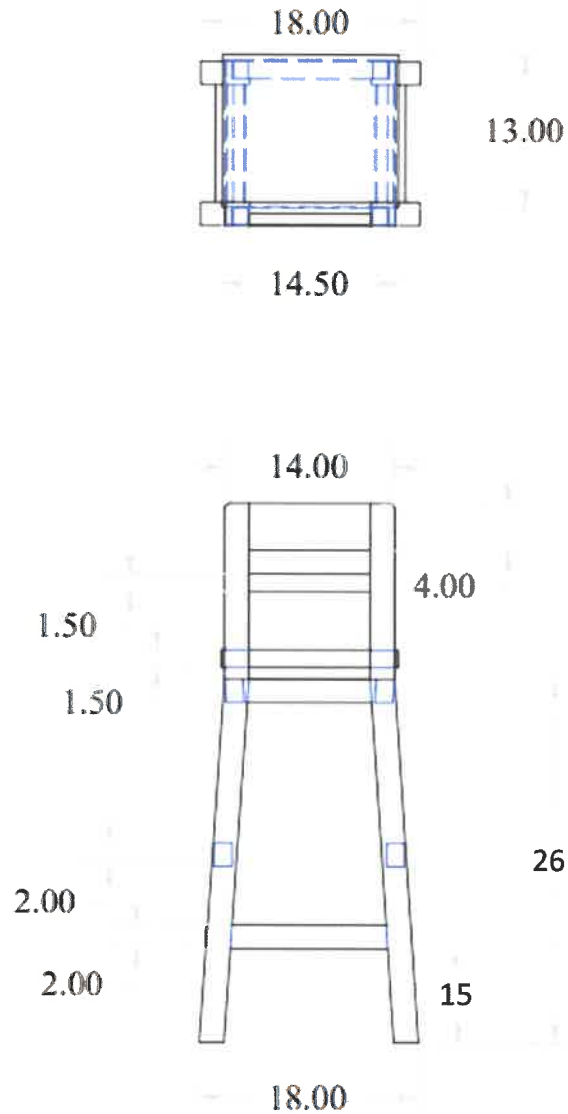
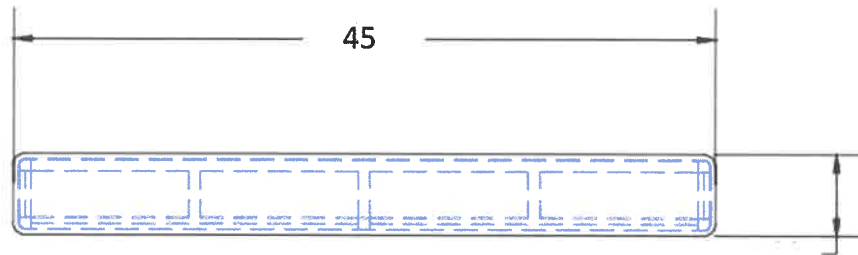

Plate Name: Chair (High)

No. of pc/s : 15
Scale: 1:13

Page No.:

9
45



Re-enforced braces underneath the Tabletop.

16

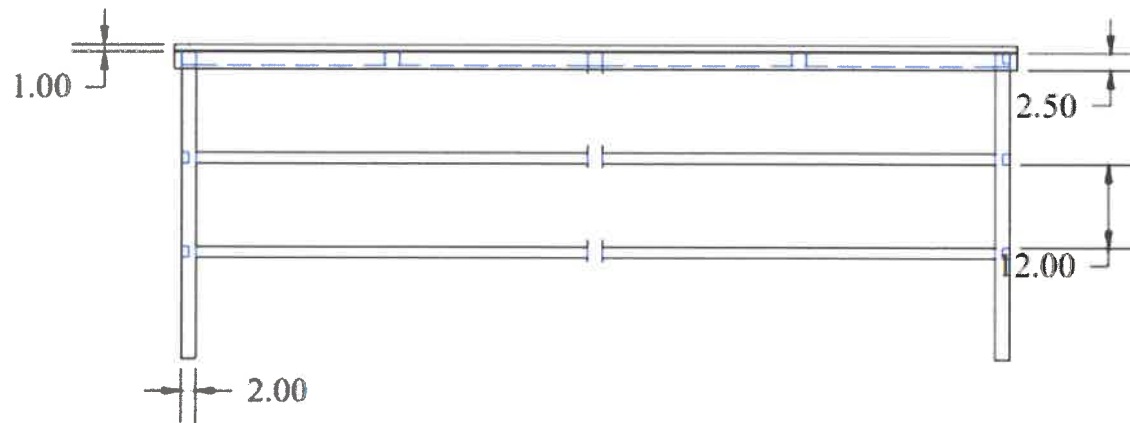
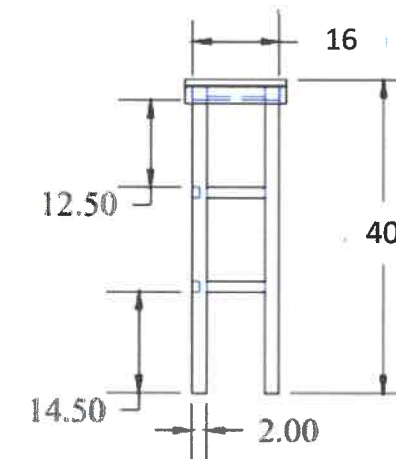
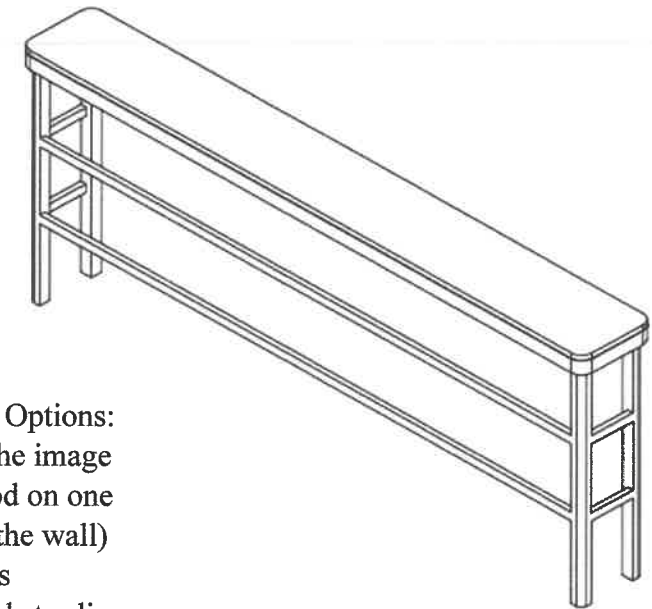

Table leg/feet braces, Options:

1. As shown in the image
(one long wood on one side, towards the wall)
2. Angle brackets
etc., as deemed sturdier



- > Hard lumber tabletop
- > Polished
- > Polyurethane, heavy-duty varnish
- > With Anti-slip base leg pads (screw/adjustable)
- . Adjustable screw (leveling feet/feet leveler)

Plate Name: Table 8 (High Table 2-2)

No. of pc/s : 10

Scale: 1:25

Page No.:

19

45

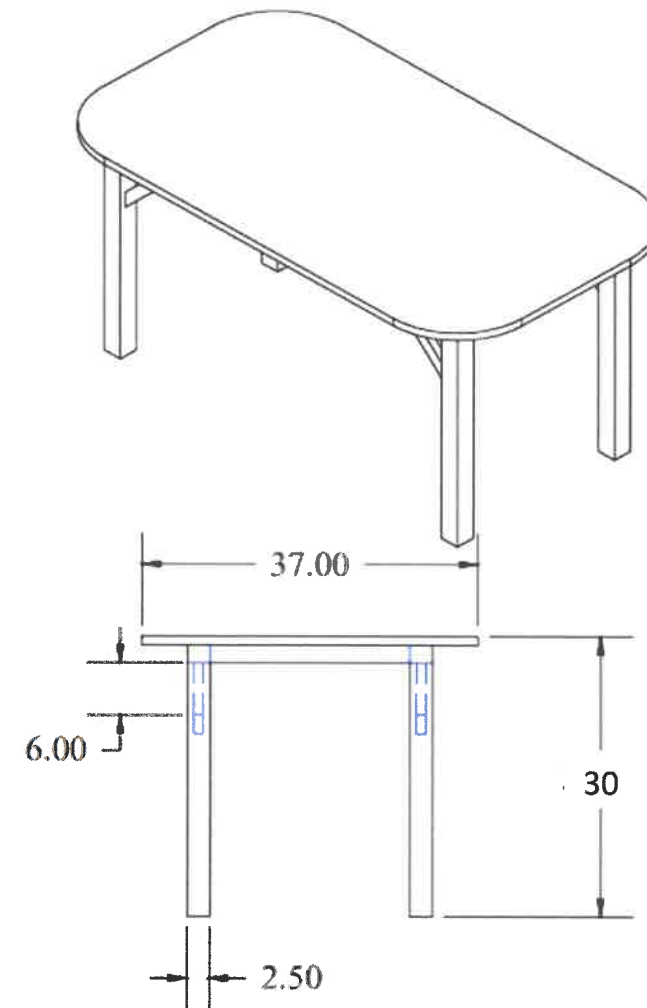
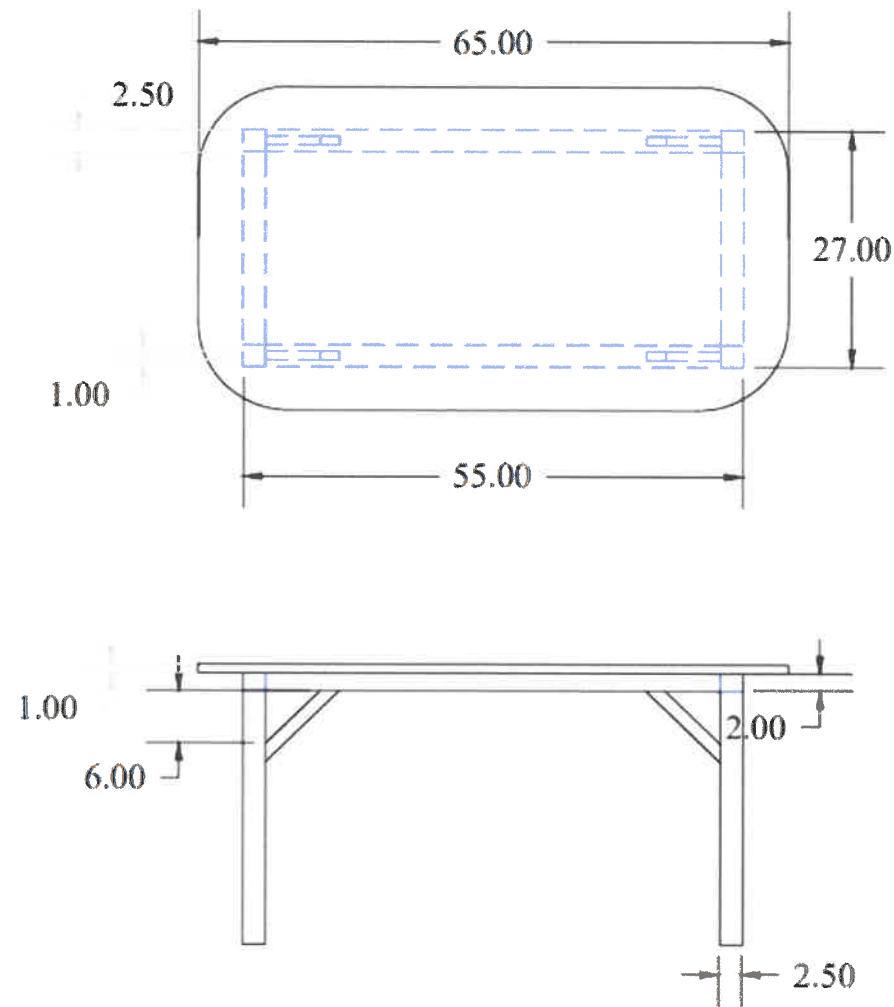

- > Hard lumber tabletop
- > Polished
- > Polyurethane, heavy-duty varnish
- > With Anti-slip base leg pads (screw/adjustable). Adjustable screw (leveling feet/feet leveler)

Plate Name: Table 1 (Oval; 6 seaters)

No. of pc/s :2
Scale: 1:20

Page No.:

12
45

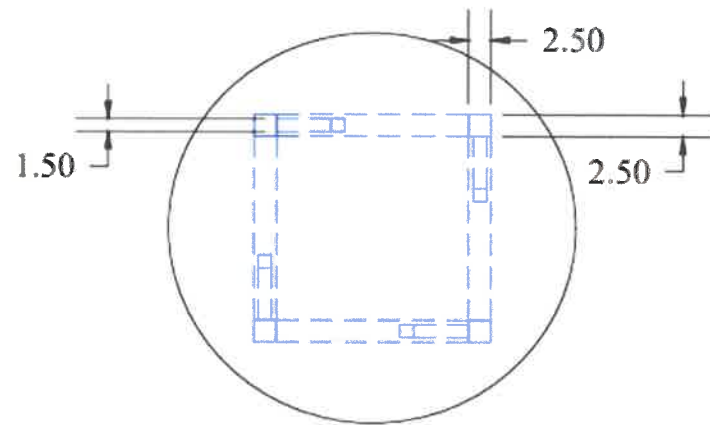

- > Hard lumber tabletop
- > Polished
- > Polyurethane, heavy-duty varnish
- > With Anti-slip base leg pads (screw/adjustable). Adjustable screw (leveling feet/feet leveler)

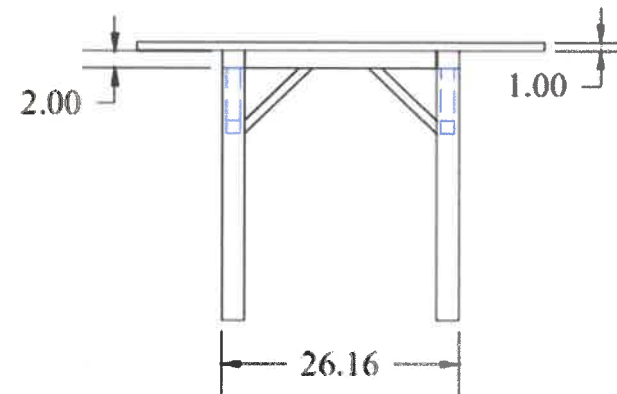
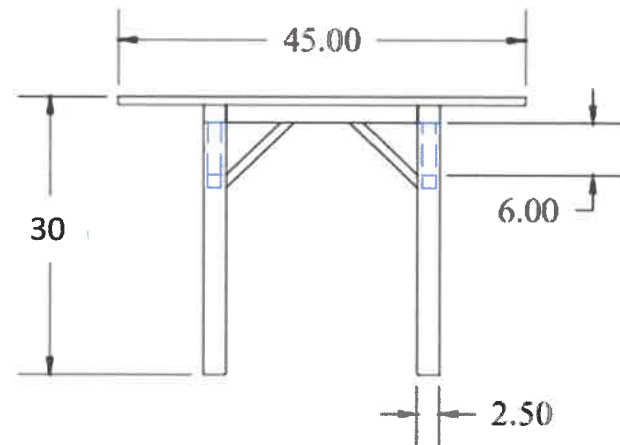
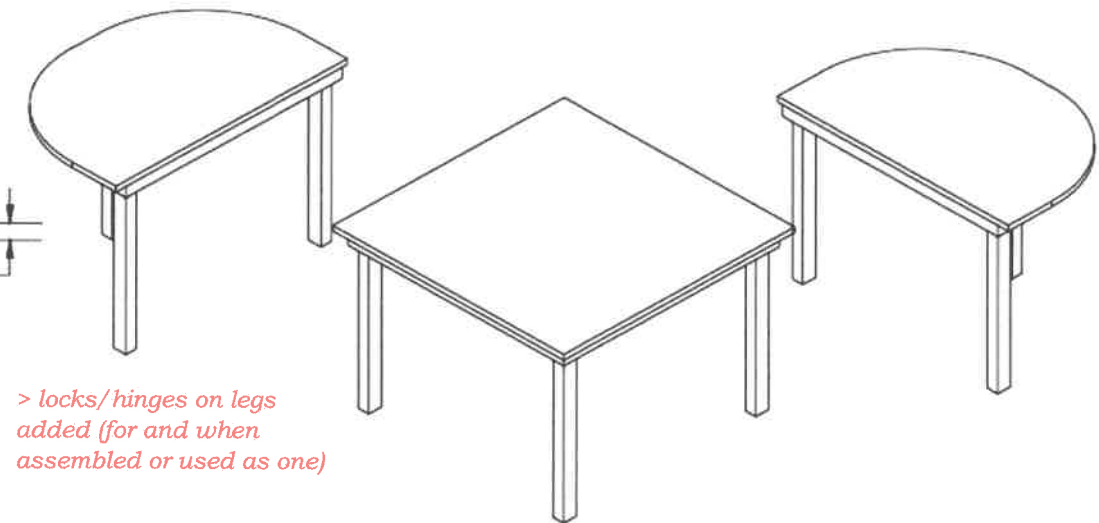
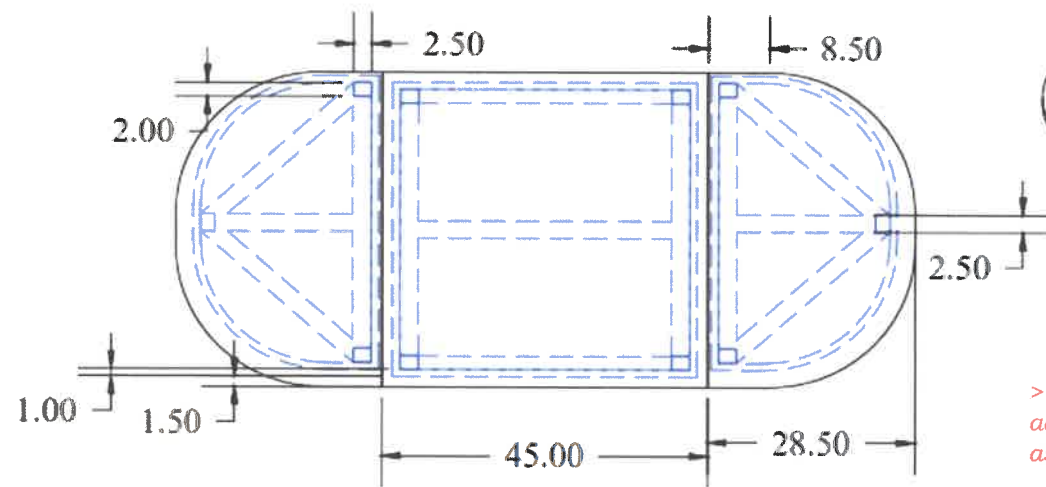

Plate Name: Table 2 (Round)

No. of pc/s :5
Scale: 1:20

Page No.:

13
45



> locks/hinges on legs
added (for and when
assembled or used as one)

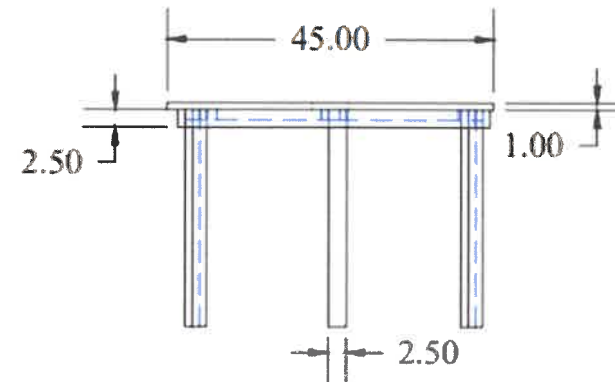
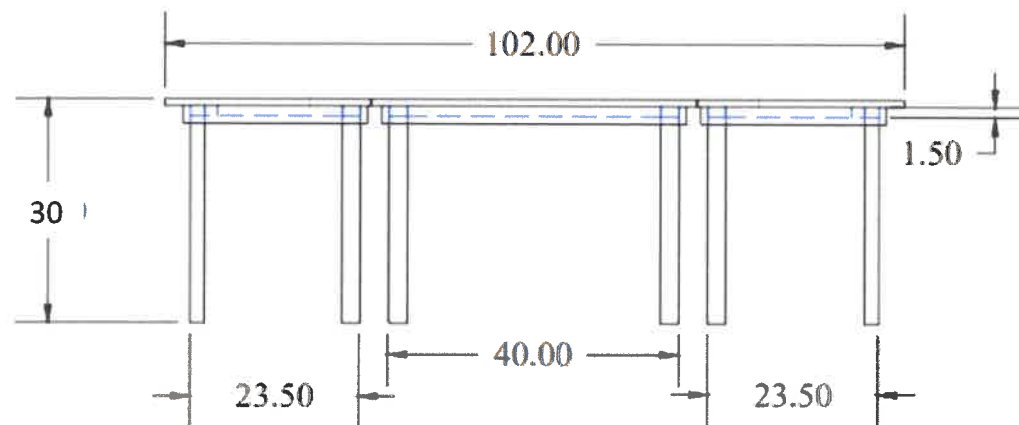

> Hard lumber
tabletop
> Polished
> Polyurethane,
heavy-duty varnish
> With Anti-slip
base leg pads
(screw/adjustable).
Adjustable screw
(leveling feet/feet
leveler)

Plate Name: Table 4 (Detachable)

No. of pc/s : 1
Scale: 1:30

Page No.:

15
45

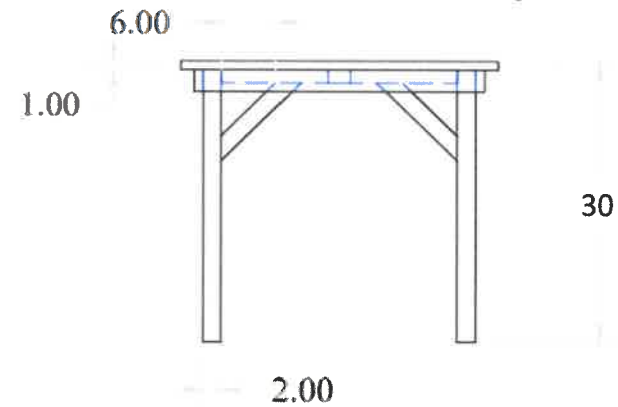
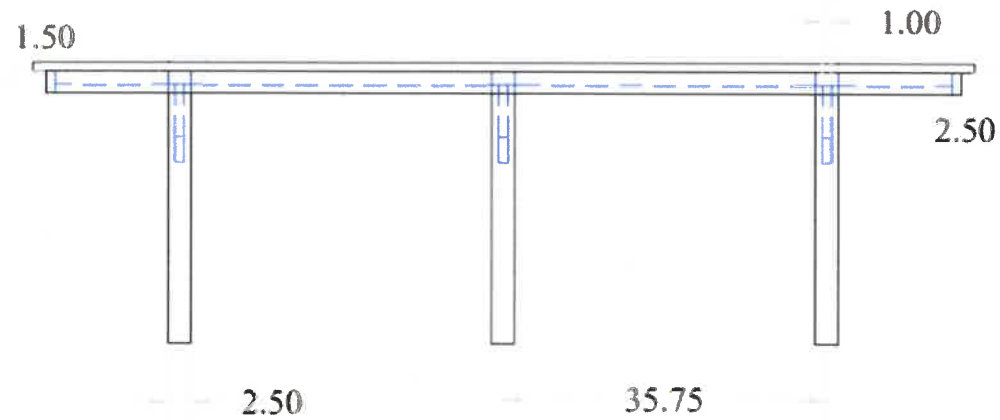
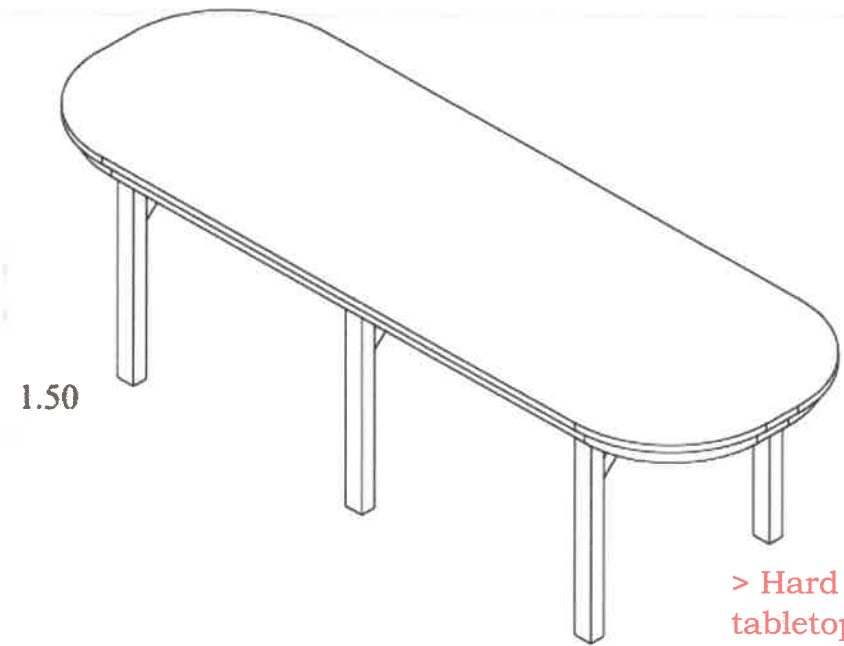
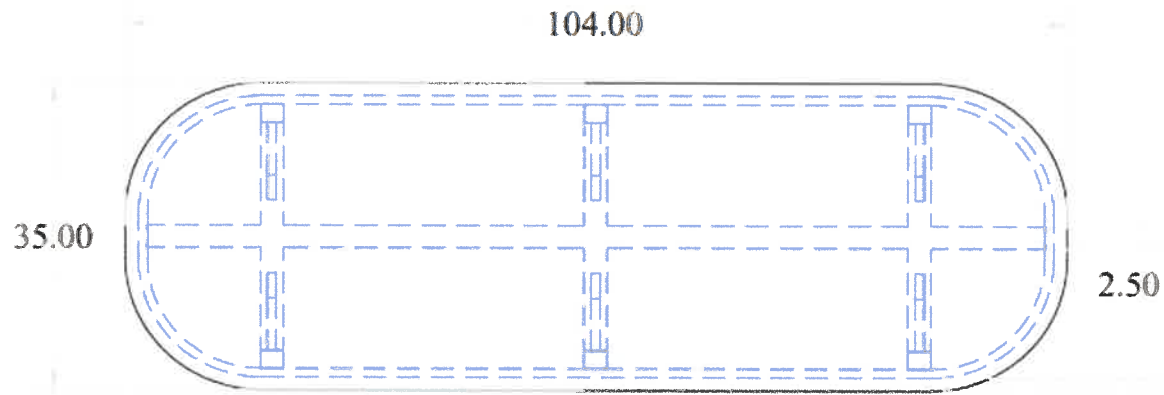

- > Hard lumber tabletop
- > Polished
- > Polyurethane, heavy-duty varnish
- > With Anti-slip base leg pads (screw/adjustable). Adjustable screw (leveling feet/feet leveler)

Plate Name: Table 5 (Oval;6-8 seaters)

No. of pc/s : 1
Scale: 1:20

Page No.:

16
45